



**S8408** 203 dpi  
**S8412** 305 dpi  
**S8424** 609 dpi



## Print Engine | S84 Series



## Industry-Leading Performance in Print and Apply Systems



Easy and intuitive large-LCD Display. Icon-driven user interface.

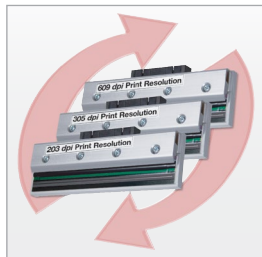

User changeable print resolution (203, 305 and 609 dpi).

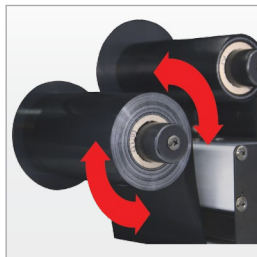

Larger ribbon roll capacity and bi-directional ribbon drive.



Available SZPL emulation provides data environment compatibility.

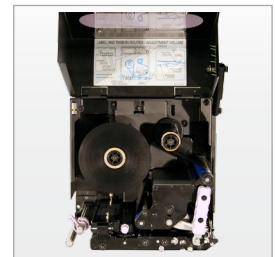

16 ips, 16 MB RAM and state-of-the-art processor get the label where you need it when you need it.



[www.satoamerica.com](http://www.satoamerica.com)



# GENERAL SPECIFICATIONS

S8408 | S8412 | S8424

MODEL		S8408	S8412	S8424
PRINTING SPECIFICATION				
Print Method		Thermal Transfer/Direct Thermal		
Print Resolution		203 dpi (8 dots/mm)	305 dpi (12 dots/mm)	609 dpi (24 dots/mm)
Print Speed		4 to 16 ips	4 to 14 ips	2 to 6 ips
Maximum Print Area	Width	4.09" (104 mm)		
	Length	98.4" (2,500 mm)	59.0" (1,500 mm)	15.7" (400 mm)
MEDIA SPECIFICATION				
Sensor Type		Adjustable Gap (See-through) Sensor, Reflective Sensor		
Media Type		Die-Cut Labels, Waste Removed, Roll, 0.125" gap		
Media Size	Width	0.5" – 5.15" (13 mm - 131 mm)		
	Length	0.6" (15 mm) to Maximum Print Area		
	Thickness	0.002" - 0.012" (0.05 mm - 0.31 mm)		
Ribbon (CSI/CSO)	Width	0.98" – 5.0" (25 mm - 128 mm)		
	Length	Maximum 3,280' (1,000 m)		
MEMORY				
Processor		32-bit RISC		
Memory		4 MB Flash ROM, 16 MB SDRAM, Optional Compact Flash		
Receive Buffer		2.95 MB maximum		
Real Time Clock		Standard		
FONT/BARCODE SYBLOGIES				
Internal Fonts	Standard	XU, XS, XM, XB, XL, Outline, OCR-A, OCR-B		
	Raster Fonts	CG Times (Serif), CG Triumvirate (San Serif)		
Barcode	Linear	UPC-A/E, EAN-8, EAN-13, Code 39, Code 93, Code 128, Codabar, MSI, Bookland, Industrial 2/5, Interleaved 2/5, Matrix 2/5, Postnet™, GS1-128, GS1-DataBar™, Intelligent Mail® Barcode (IMB)		
	2-D	PDF417, Micro PDF417, Truncated PDF417, Maxicode™, Data Matrix, QR Code, Composite Symbology		
COMMUNICATION INTERFACES				
Standard		1 per printer: IEEE1284 (Parallel); RS232C (25-pin); USB; Ethernet (10BaseT/100BaseTX auto-switching); Wireless LAN (802.11g); RS422/485		
EXT Port (Applicator Interface)		14-Pin Centronics style connector (opt. 25-pin D-sub)		
OPERATING CHARACTERISTICS				
Power Requirements		100 - 240 VAC (+/- 10%); 50/60 Hz; Auto-Switching		
Environment	Operating	41° - 104°F (5° - 40°C); 15% - 85% RH, non-condensing		
	Storage	0° - 140°F (-20° - 60°C); 15% - 85% RH, non-condensing		
Dimensions		9.7" (245 mm) W x 16.1" (408 mm) D x 11.8" (300 mm) H		
Weight		35.2 lbs (16.0 kg) Standard Configuration		

The acronyms used to identify the programming languages of non-SATO products may be the property of their respective companies and are used here to identify their various programming languages, used only for explanation without intent to infringe. SATO makes no claims to the authenticity of their command language or functionality.

## Label Gallery 3—Label Design Software

### LG Easy—Entry-Level

- Entry-level labeling software
- Linear and standard 2D barcodes
- Wizard-based basic barcode labeling



### LG Plus—Advanced

- Advanced & compliance label design
- RFID support (HF & UHF/EPC)
- Complete database support
- API programming interface (ActiveX, .NET)
- Downloading to memory
- VB scripting
- System management (user login, reprint support)
- Print only version



### LG True Pro with WinCE

- All features of Plus Version
- RFID support (HF & UHF/EPC)
- Middleware integration module
- Creating standalone label applications
- Mobile wireless printing (WinCE support)
- Network version
- Label format export (SAP R/3 ITF, XML)
- Programming integration option



## SATO AMERICA, INC. CORPORATE

10350-A Nations Ford Rd  
Charlotte, NC 28273  
Phone: (704) 644-1650  
Fax: (704) 644-1662  
satosales@satoamerica.com

## LABEL MANUFACTURING, SERVICE & SALES

UNITED STATES MEXICO CENTRAL AMERICA  
CANADA CARIBBEAN

[www.satoamerica.com](http://www.satoamerica.com)

©2014 SATO America, Inc. All rights Reserved. Rev H • Any unauthorized reproduction of this content, in part or whole, is strictly prohibited • SATO is a registered trademark of SATO Corporation and its subsidiaries in Japan, the U.S. and other countries. All other trademarks are the property of their respective owners.

# Legacy Technology Services

**We Rent & Sell All Types Of Barcode Equipment**

Call now to talk to an expert

**866-271-9891**

[www.LegacyGlobal.com](http://www.LegacyGlobal.com)

Some brands we carry



MOTOROLA

**Intermec**

**DATALOGIC**™

**Honeywell**

**EQUINOX**  
PAYMENTS



## About us

- Legacy Technology Services is a leading nationwide provider of mobile computing, barcode, printers and point of sale equipment and services.
- For over a decade, thousands of clients across North America have trusted us to provide equipment from leading manufacturers backed by the services to support them.

## Latest Hardware from top manufacturers

- Legacy handles virtually every major manufacturer of mobile computing, barcoding and point of sale equipment.

## Expert Repair and Maintenance services

- Legacy is one of the best repair facilities in North America

## Discontinued product sourcing

- They don't make it anymore? Our inventory also includes manufacturer close-outs and discontinued equipment to support our clients legacy infrastructure.

## Trade-in and Disposal services

- That old equipment laying around your facility may still have some value. Legacy routinely purchases equipment from our clients around the globe.
  - Data destruction
  - Hardware disposal
  - Auditing services

## Dedicated client account team

- Dedicated, highly trained account managers are here to answer all your questions and provide top notch service.

## Equipment rental services

- Sometimes renting is a better solution, Legacy's huge rental inventory provides the equipment you need for temporary needs and projects.



[Legacy, Inc.](http://Legacy, Inc.)

160 West Road,  
Ellington, CT 06029

Toll Free: 866-271-9891

Fax: 888-522-4684